



UNITED BRASS WORKS, INC.

714 S. Main St. Randleman, N.C. 27317

Tel: 800-334-3035 Fax: 800-498-4696



Model 235 Ball Drip Valve

200 lbs. WOG



**Valve unseats only by force of gravity
causing ball to fall off seat.**

Use only in horizontal position.

**Do Not Use with more than
1 ft. of head (water pressure) on ball
check.**

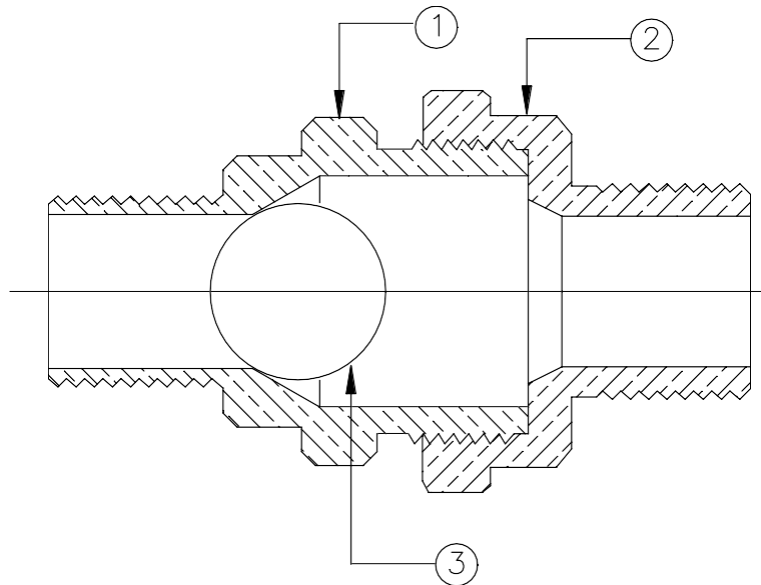

MATERIAL LIST

NO.	DESCRIPTION	MATERIAL
1	Body	Brass
2	Tail Piece	Brass
3	Ball	Stainless Steel

Size	1/2"	3/4"
Ship Wgt. (lbs.)	0.43	0.56
Qty. Unit Pack	12	12